

More information:
www.blug.es/eng/productos/

BLUG[®]
 Credeblug, s.l.

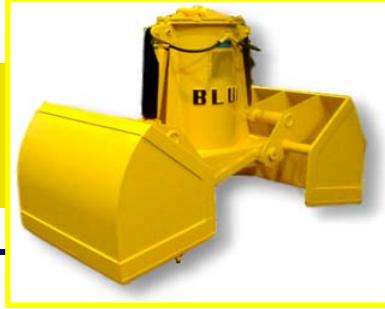

REFERENCE
C2-1,1



p. 20

RELATED PRODUCTS



C2H-1,1



C2AP-1,1



CM4-1,1

MACHINE TYPE
CLAMSHELL GRAB
WORKING SYSTEM
ELECTRO-HYDRAULIC
MATERIAL TO BE HANDLED

MAXIMUM MATERIAL DENSITY
1,1 T/M³
CYLINDER QUANTITY
2

PILED AND BULK MATERIAL UP TO 1,1 t/m³ DENSITY

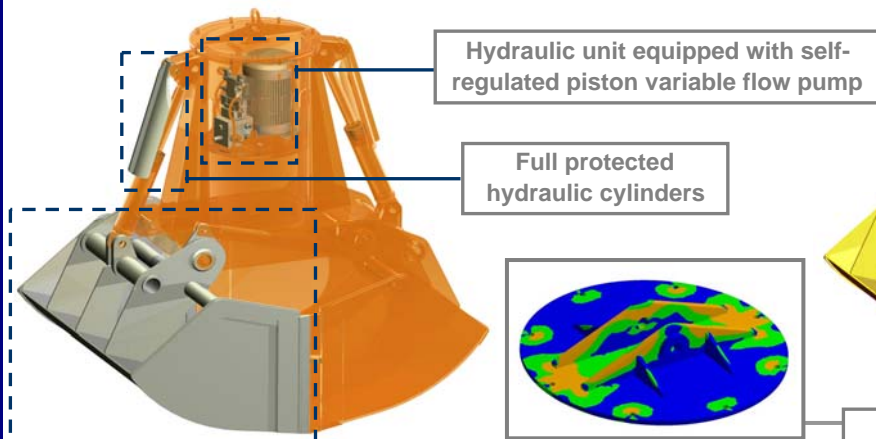

Clamshell design with optimal penetration that allows full loading in all the operations thanks to a kinematic design at lifting and penetration mode including wear resistant lips

EQUIPMENT NEEDED

- Hook(s) or lifting chain(s).
- Electric connection for hydraulic unit.

TECHNICAL INFORMATION

- Robust structure in S355 J2G3 rolled steel.
- Oil tank tightly enclosed and protected from environment impurities.
- Reduced height, multi-stable, can work at any angle ($\pm 60^\circ$).
- Design & fabrication according to standard FEM 1001/98 section I.
- CE conformity.

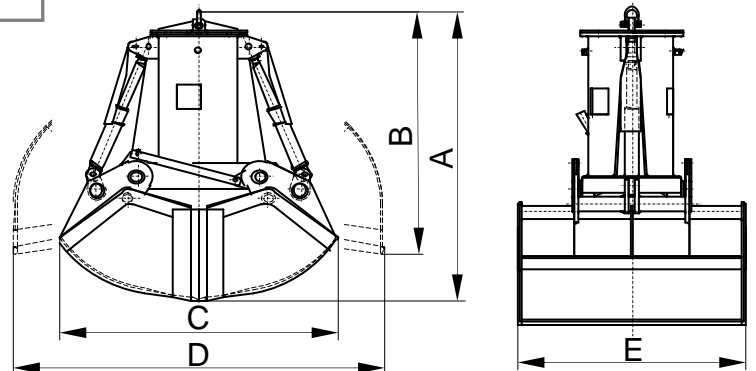

Reference	Capacity		Engine 40% ED	Intensity 400 V	Working pressure	Closing time	Opening time	Crane SWL	Weight	Dimensions				
	m ³	kW								mm				
			A	bar	s	s	t	kg	A	B	C	D	E	
C2-1250-1,1	1,25	7,3	14,5	100	8	4	3,2	1370	2130	1830	1750	2330	1400	
C2-1500-1,1	1,5	7,3	14,5	120	8	4	3,2	1420	2190	1840	1850	2445	1500	
C2-2000-1,1	2	7,3	14,5	145	9	5	4	1520	2280	1855	2000	2625	1680	
C2-2500-1,1	2,5	7,3	14,5	180	10	5	5	1610	2350	1865	2150	2760	1850	
C2-3000-1,1	3	7,3	14,5	140	13	7	6,3	2380	2540	2120	2250	3010	2000	
C2-3500-1,1	3,5	10	20	160	13	7	8	2470	2610	2130	2350	3150	2100	
C2-4000-1,1	4	10	20	185	13	7	8	2570	2670	2145	2450	3270	2200	

SUBJECT TO CHANGE WITHOUT NOTICE.

You can request any model's offer visiting our web site www.blug.es or sending an email to comercial@blug.es