

More information:
www.blug.es/eng/productos/

BLUG[®]
 Credeblug, s.l.

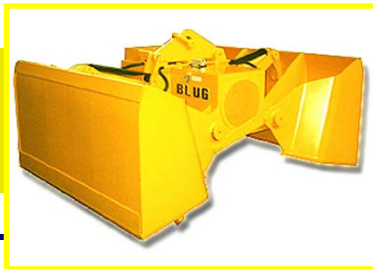

REFERENCE
C2H-1,1

p. 21

MACHINE TYPE
CLAMSHELL GRAB

MAXIMUM MATERIAL DENSITY
1,1 T/M³

WORKING SYSTEM

TYPE

ELECTRO-HYDRAULIC
 MATERIAL TO BE HANDLED

LOW HEIGHT



C2-1,1



C2AP-1,1



C4-1,1

PILED AND BULK MATERIAL UP TO 1,1 t/m³ DENSITY

Hydraulic unit in horizontal position to reduce grab's height and equipped with self-regulated piston variable flow pump

Full protected hydraulic cylinders

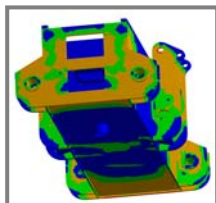

Structure validated by Finite Elements Analysis

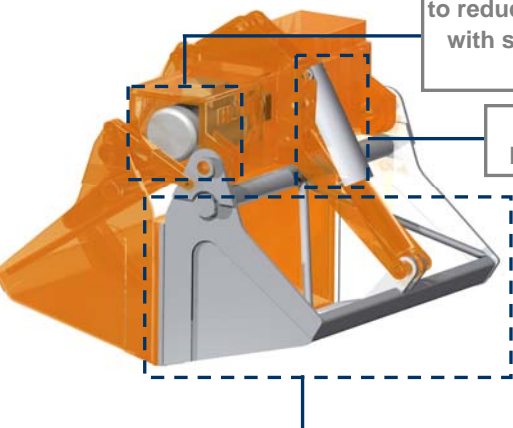

Clamshell design with optimal penetration that allows full loading in all the operations thanks to a kinematic design at lifting and penetration mode including wear resistant lips

EQUIPMENT NEEDED

- Hook(s) or lifting chain(s).
- Electric connection for hydraulic unit.

TECHNICAL INFORMATION

- Robust structure in S355 J2G3 rolled steel.
- Oil tank tightly enclosed and protected from environment impurities.
- Reduced height, multi-stable, can work at any angle ($\pm 60^\circ$).
- Design & fabrication according to standard FEM 1001/98 section I.
- CE conformity.

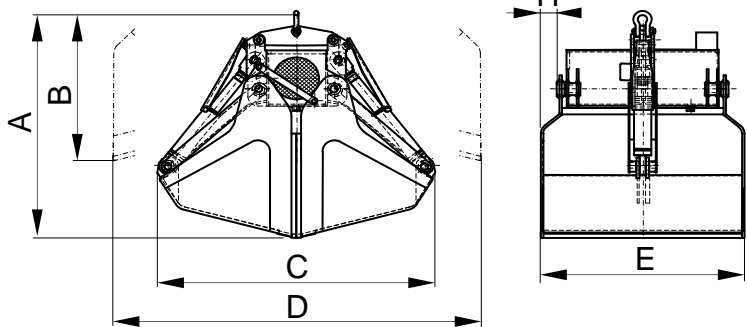

Reference	Capacity	Engine 40% ED	Intensity 400 V	Working pressure	Closing time	Opening time	Crane SWL	Weight kg	Dimensions mm					
	m ³	kW	A	bar	s	s			t	A	B	C	D	E
C2H-1500-1,1	1,5	7,3	14,5	150	9,5	5	3,2	1490	1630	1040	1840	2540	1700	120
C2H-2000-1,1	2	10	20	200	9,5	5	4	1680	1735	1060	1985	2725	1950	245
C2H-3000-1,1	3	10	20	170	14	7	6	2625	2065	1500	2485	3220	1800	0
C2H-4000-1,1	4	14,5	28	220	14	7	8	2930	2190	1355	2695	3465	2100	150
C2H-5000-1,1	5	14,5	28	180	13	6	10	3400	2335	1430	2870	3725	2305	205
C2H-6000-1,1	6	20,5	39	220	13	6	12	3710	2465	1465	3060	3965	2305	205
C2H-7000-1,1	7	25,5	48,5	190	13	6	14	4730	2580	1540	3225	4125	2500	255
C2H-8000-1,1	8	25,5	48,5	220	13	6	16	5020	2630	1555	3295	4225	2700	355

SUBJECT TO CHANGE WITHOUT NOTICE.

You can request any model's offer visiting our web site www.blug.es or sending an email to comercial@blug.es