

More information:  
[www.blug.es/eng/productos/](http://www.blug.es/eng/productos/)

**BLUG**<sup>®</sup>  
 Credeblug, s.l.

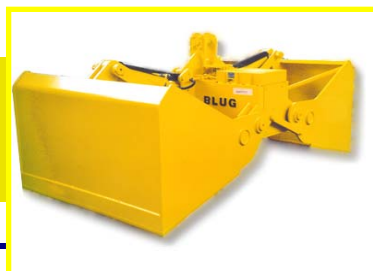

REFERENCE  
**C2H-1,8**

p. 25

RELATED PRODUCTS



**C2-1,8**



**CV2-1,8**



**CM4-1,8**

MACHINE TYPE  
**CLAMSHELL GRAB**

WORKING SYSTEM  
**ELECTRO-HYDRAULIC**

MATERIAL TO BE HANDLED

MAXIMUM MATERIAL DENSITY  
**1,8 T/M<sup>3</sup>**

TYPE  
**LOW HEIGHT**

PILED AND BULK MATERIAL UP TO 1,8 t/m<sup>3</sup> DENSITY

Hydraulic unit in horizontal position to reduce grab's height and equipped with self-regulated piston variable flow pump

Full protected hydraulic cylinders

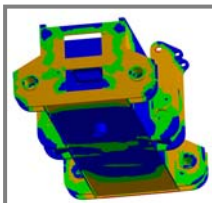

Structure validated by Finite Elements Analysis

Clamshell design with optimal penetration that allows full loading in all the operations thanks to a kinematic design at lifting and penetration mode including wear resistant lips

**EQUIPMENT NEEDED**

- Hook(s) or lifting chain(s).
- Electric connection for hydraulic unit.

**TECHNICAL INFORMATION**

- Robust structure in S355 J2G3 rolled steel.
- Oil tank tightly enclosed and protected from environment impurities.
- Reduced height, multi-stable, can work at any angle ( $\pm 60^\circ$ ).
- Design & fabrication according to standard FEM 1001/98 section I.
- CE conformity.

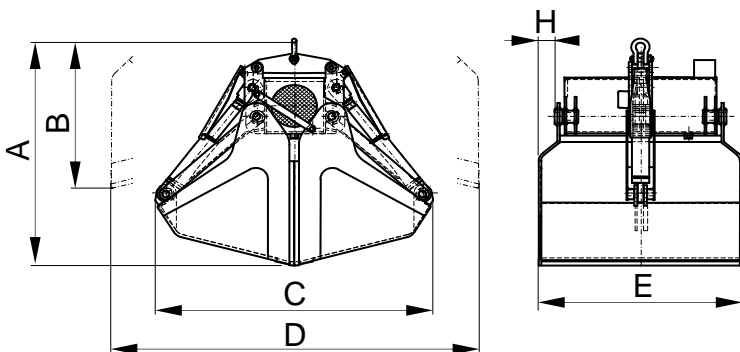

Reference	Capacity	Engine 40% ED	Intensity 400 V	Working pressure	Closing time	Opening time	Crane SWL	Weight kg	Dimensions mm					
	m <sup>3</sup>	kW	A	bar	s	s			A	B	C	D	E	H
C2H-1250-1,8	1,25	10	20	160	8	4	4	1550	1750	1200	1650	2200	1800	200
C2H-1600-1,8	1,6	10	20	205	8	4	5	1700	1770	1210	1650	2250	2100	350
C2H-2000-1,8	2	15	28,5	165	9,5	5	6,3	2100	2000	1350	2000	2550	2100	250
C2H-2500-1,8	2,5	15	28,5	205	9,5	5	8	2250	2100	1360	2000	2700	2400	400
C2H-3200-1,8	3,2	20	38	210	12,5	6	10	2900	2300	1500	2300	3000	2400	300
C2H-4000-1,8	4	20	38	230	14,5	7	12,5	3100	2400	1530	2300	3100	2700	600
C2H-5000-1,8	5	25	49	225	15	7	12,5	3800	2500	1650	2800	3360	2700	700

SUBJECT TO CHANGE WITHOUT NOTICE.

You can request any model's offer visiting our web site [www.blug.es](http://www.blug.es) or sending an email to [comercial@blug.es](mailto:comercial@blug.es)