

More information:
www.blug.es/eng/productos/

BLUG[®]
 Credeblug, s.l.



REFERENCE
C2H-2,8

p. 29

MACHINE TYPE
CLAMSHELL GRAB

MAXIMUM MATERIAL DENSITY
2,8 T/M³

WORKING SYSTEM
ELECTRO-HYDRAULIC

TYPE
LOW HEIGHT

MATERIAL TO BE HANDLED
PILED AND BULK MATERIAL UP TO 2,8 t/m³ DENSITY



Hydraulic unit in horizontal position to reduce grab's height and equipped with self-regulated piston variable flow pump

Full protected hydraulic cylinders

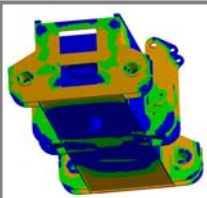

Structure validated by Finite Elements Analysis

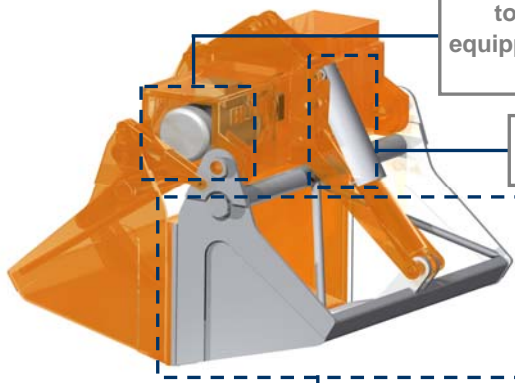

Clamshell design with optimal penetration that allows full loading in all the operations thanks to a kinematic design at lifting and penetration mode including wear resistant lips

EQUIPMENT NEEDED

- Hook(s) or lifting chain(s).
- Electric connection for hydraulic unit.

TECHNICAL INFORMATION

- Robust structure in S355 J2G3 rolled steel.
- Oil tank tightly enclosed and protected from environment impurities.
- Reduced height, multi-stable, can work at any angle ($\pm 60^\circ$).
- Design & fabrication according to standard FEM 1001/98 section I.
- CE conformity.

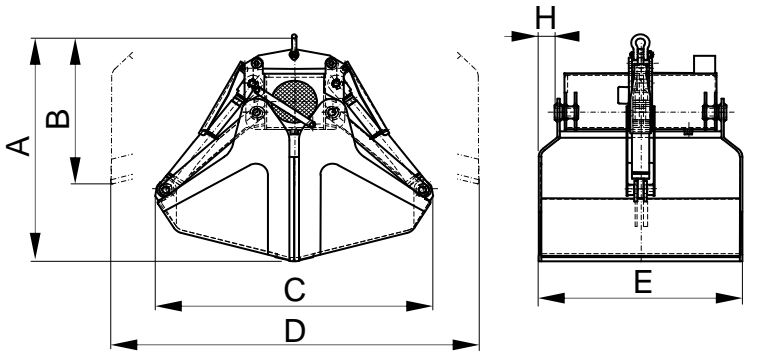

Reference	Capacity		Engine 40% ED	Intensity 400 V	Working pressure	Closing time	Opening time	Crane SWL	Weight kg	Dimensions mm					
	m ³	kW								A	B	C	D	E	H
C2H-800-2,8	0,8	10	20	160	8	4	4	1450	1650	1120	1610	2050	1400	0	
C2H-1000-2,8	1	10	20	190	8	4	5	1600	1650	1120	1610	2150	1600	100	
C2H-1250-2,8	1,25	15	28,5	160	9,5	5	6,3	2000	1900	1260	1950	2370	1600	0	
C2H-1600-2,8	1,6	15	28,5	190	9,5	5	8	2200	1900	1260	2370	2750	1800	100	
C2H-2000-2,8	2	20	38	195	12,5	6	10	2890	2100	1400	2300	2750	1800	0	
C2H-2500-2,8	2,5	20	38	230	12,5	6	12	3050	2100	1400	2300	2750	2100	150	
C2H-3200-2,8	3,2	25	49	230	15	7	16	3400	2400	1600	2800	3200	2100	150	

SUBJECT TO CHANGE WITHOUT NOTICE.

You can request any model's offer visiting our web site www.blug.es or sending an email to comercial@blug.es