

**BLUG**<sup>®</sup>  
 Credeblug, s.l.



**MATERIAL TO BE HANDLED**  
**ARCH-STONES**

**WORKING AXIS**  
 HORIZONTAL

**RELATED PRODUCTS**



**PMS-302**



**PEB-200**



**GG-103**

**MACHINE TYPE**  
**TONG**

**WORKING SYSTEM**  
**ELECTRO-MECHANICAL**

**OTHER POSSIBLE MATERIALS**

**UP TO 4 ARCH-STONES HANDLING AT THE SAME TIME**

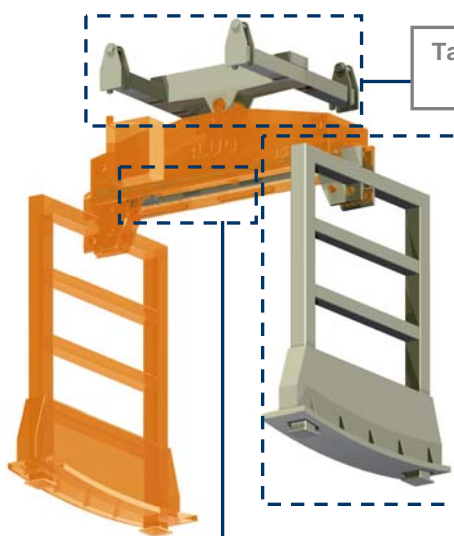

Taylor made lifting block with 4 points attachment

Specific arm design for arch-stones handling with wear resistant steel in contact surfaces

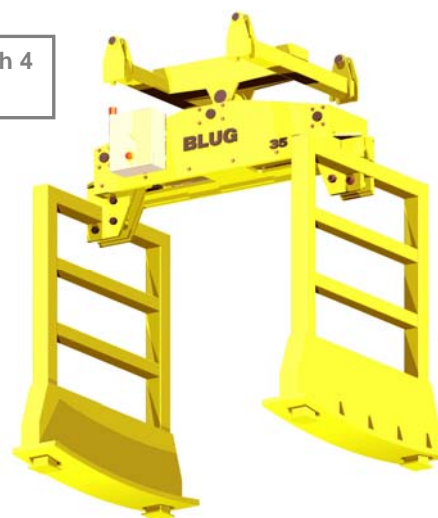

Structure validated by Finite Elements Analysis

Interchangeable guides for arms' linear displacement with speed control and mechanical brake.



**EQUIPMENT NEEDED**

- Lifting hook.
- Electric connection for electro-mechanical system.

**TECHNICAL INFORMATION**

- Robust structure in S355 J2G3 rolled steel.
- Luminous signposting of status.
- Gripping force protection system.
- Maximum / minimum opening control device.
- Safety switch to avoid opening when loaded.
- Design & fabrication according to standard FEM 1001/98 section I.
- CE conformity.

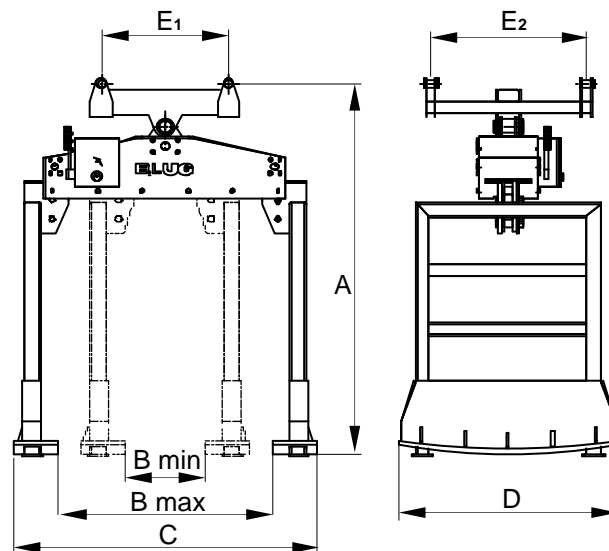

Reference	Capacity	Engine	Intensity 400 V	Arch-stones exterior radius	Crane SWL	Weight		Dimensions mm				
						t	kg	A	Bmax	Bmin	C	D
PED-201-10	10	1,5	3,4	2750	12,5	2500	2880	800	550	1400	2000	To define
PED-201-20	20	1,5	3,4	3725	25	3250	3050	1350	1000	1950	2000	
PED-201-30	30	2,2	5,15	5520	35	3900	3350	1850	1200	2550	2000	
PED-201-35	35	2,2	5,15	5770	40	4200	3650	1950	1150	2750	2000	

SUBJECT TO CHANGE WITHOUT NOTICE.

You can request any model's offer visiting our web site [www.blug.es](http://www.blug.es) or sending an email to [comercial@blug.es](mailto:comercial@blug.es)